

Instructions of Use

Silva Travel-Lite®

SPECIALISED RANGE

Reference: **SP-SIL/TL-IOU**

Product Code/s: **SIL-TL-XXXSM, SIL-TL-XXSM,**

SIL-TL-XSM, SIL-TL-SM, SIL-TL-MED

Revision: **11.06.2021**

Copyright & Design Rights: **Silvalea**



WARNING

This product is **ONLY** hoistable with a loop fixing spreader bar. **PLEASE DO NOT USE** on a stud fixing spreader bar.

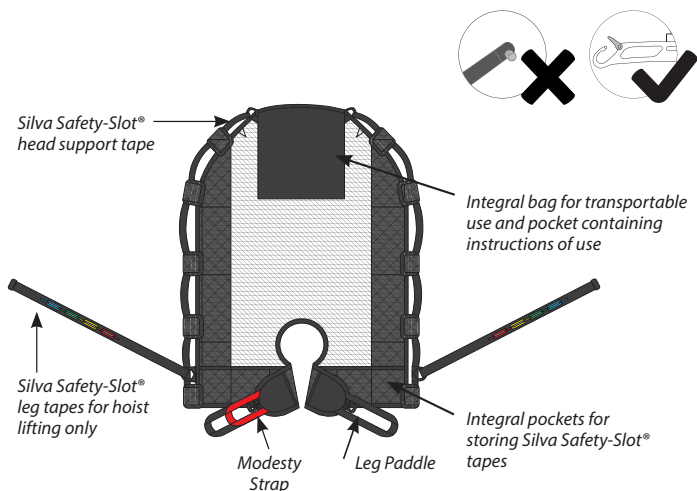

Manual Transfer Sling Application:



Apply the sling down the back of the patient.

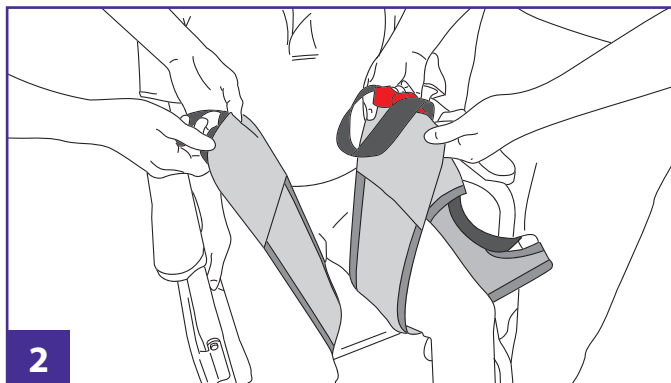

Take each leg paddle under the patient's thighs.

Manual Transfer Sling Application Continued:

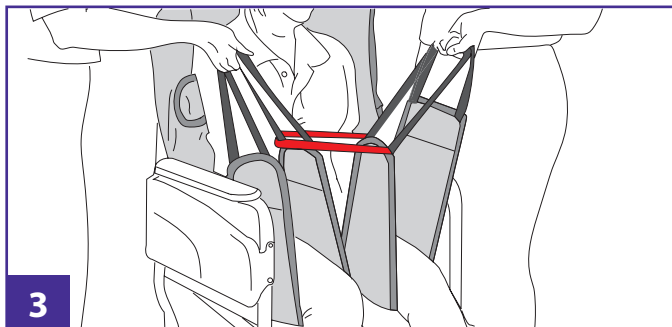

Connect the leg sections together by linking one inner leg loop through the red modesty strap. Each carer to take both inner and outer leg tapes together in one hand.

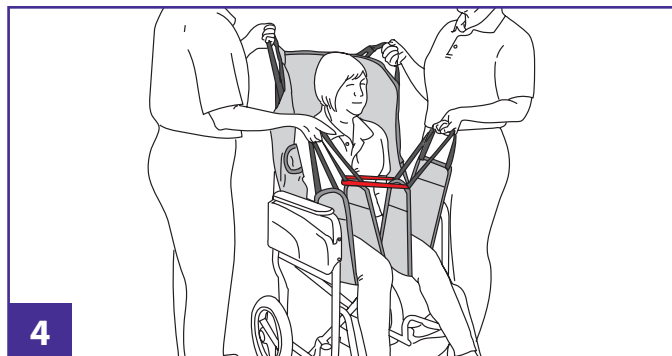

Take each corner to the top head support loop (plus shoulder loop if required) in the other hand to facilitate a lift. It may be necessary to use additional carers.

Hoist Transfer Sling Application:

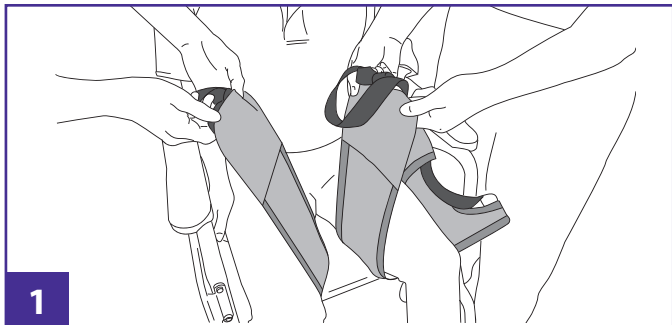

Apply sling down the back of the patient. Take each paddle under the patient's thighs.

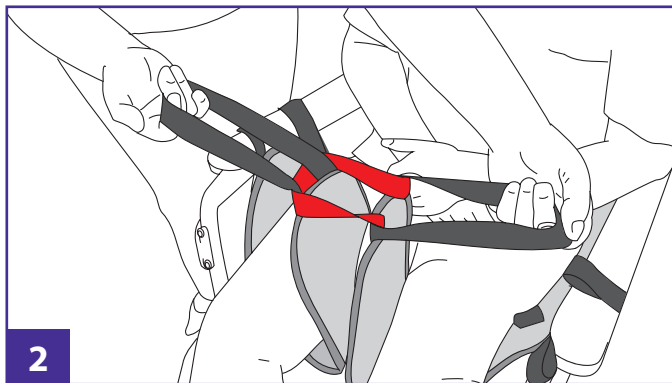

Connect the leg sections together by linking one inner leg loop through the red modesty strap.

Hoist Transfer Sling Application Continued:

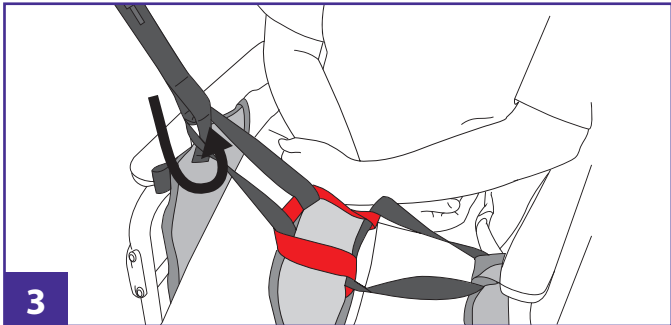

Remove the Silva-Safety Slot® tapes from the pockets. Feed outer tape through inner leg loop and attach required slot to hoist. Repeat the other side.

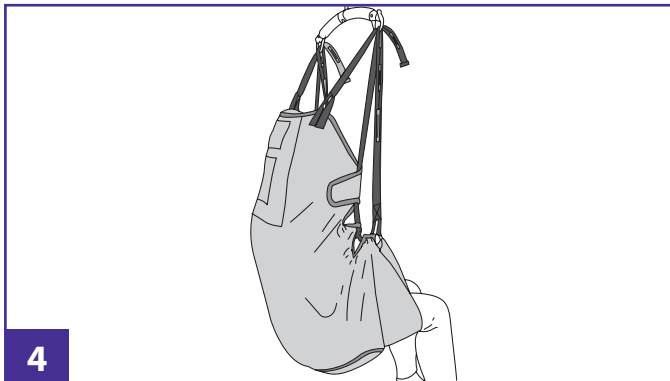

Once the leg tapes have been attached to hoist, attach Silva- Safety Slot® at the head support.

Important:



For Manual Use: it is essential that more than one person is available to transport the patient and that current manual handling guidelines are observed at all times. If in any doubt consult your Moving & Handling Advisor.

For Hoistable Use: This sling is designed for a general purpose transfer from a recumbent or seated position.

If the sling is to remain in position under the patient it must be subject to a risk assessment. The patient must be assessed by a competent person who is fully trained in the suitability, application and fitting of the sling. Carers should always be trained in the use of hoists and slings. Correct sizing of a sling is important, if in any doubt consult your Moving and Handling Advisor.

Service Label & Sling Checks:

All products should be checked each time they are used for any signs of deterioration. Please Check:

- braiding/tapes for deterioration and fraying
- material for holes/snagging
- compatibility with the hoist
- safe working load of both the hoist and sling/product (if applicable)
- label is legible

Remove from use immediately if there are any signs of deterioration to the sling or tapes or the label is illegible. The Service Label is a visual indicator of when the 6-monthly or annual hoist inspection has been completed. This is in line with LOLER (Lifting Operations and Lifting Equipment Regulations).

Warranty:

Silvalea offers a 12 month manufacturers warranty on all products unless otherwise stated. Scan QR Code or visit our website downloads page for more information. **If any serious accident has occurred in relation to any of the devices provided by Silvalea, please report immediately using the contact details provided and to the Competent Authority of the Member State in which the user/patient is established.**



Washing Guidelines:

- Follow laundry temperatures for washing and drying detailed on the product label.
- Always ensure that all Hook & Loop fastenings are fully closed before washing.
- All products should be laundered using non-biological detergents.
- Metal fixings are sometimes used in our products. Care should be taken to ensure that all products containing metal attachments are washed in a pillowcase or wash bag to prevent damage to the product or to washing equipment. Silvalea accept no liability for damage to laundry equipment.
- DO NOT IRON
- Silva-Superfine with COOLMAX® mesh slings are provided with a wash bag. The wash bag MUST be used during laundering.

Product Care:

- This sling should not come into contact with any sharp or rough edges as this could cause snagging and will result in deterioration of the sling
- Ensure that any Hook & Loop fastenings are closed when not in use. This will prevent unnecessary snagging of the sling material and prevent clogging of the Hook & Loop.
- Launder regularly.
- Store products in a suitable dry clean place.
- Silvalea will accept no liability for any additions/adaptations made to our products that have NOT been carried out by ourselves. Doing so may cause serious injury or death to the user.

Drying Guidelines:

- Follow the recommended drying temperatures as stated on product label.
- Overheating a textile product can cause deterioration in the material components.
- Do not place the product on a convactor heater or steam pipes.



SCAN ME



My Sling in a Bag

www.silvalea.com

customerservices@silvalea.com +44 (0)1626 331 655



Silvalea Ltd Silverhills Buildings, Decoy Ind Estate, Newton Abbot, Devon, TQ12 5LZ. UK

UK
CA



ADVENA Ltd. Tower Business Centre, 2nd Floor, Tower Street, Swatar, BKR 4013. Malta

Silvalea Ltd a division of  **savaria**. Copyright 2021 © All rights reserved

This product is protected by a Community Design Registration No. 005 510 922 (2016) Design Rights: Silvalea Ltd 2016 - 2021. Copyright 2021 © Silvalea Ltd. All rights reserved
Copyright & Design Rights: Silvalea. Silvalea Ltd is the exclusive licensee of the trademark. Silva-Superfine® is a registered trademark of Silvalea Ltd. Silvalea Ltd is the exclusive licensee of the trademark. Silva-Safety Slot® is registered trademark of D-ansermed Ltd. All rights reserved. COOLMAX® is a registered trademark of the LYCRA Company.

DISCLAIMER: Please note that Silvalea reserve the right to make amendments/changes to designs without prior notice. These changes are conducted via research and development reviews and are done in a bid to enhance our products and improve care-giver and client experience.